

NOTES: UNLESS OTHERWISE SPECIFIED:

© COPYRIGHT 2017 TEXAS INSTRUMENTS
UNPUBLISHED, ALL RIGHTS RESERVED

REVISIONS			
REV	DESCRIPTION	DATE	BY
A	INITIAL RELEASE	7-17-2017	SS

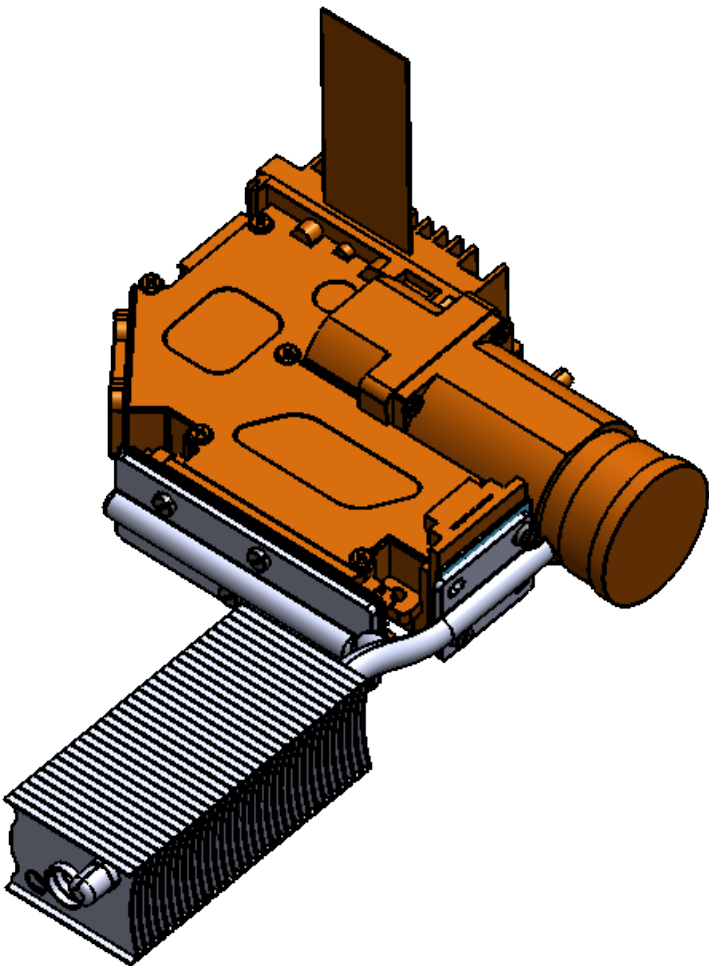
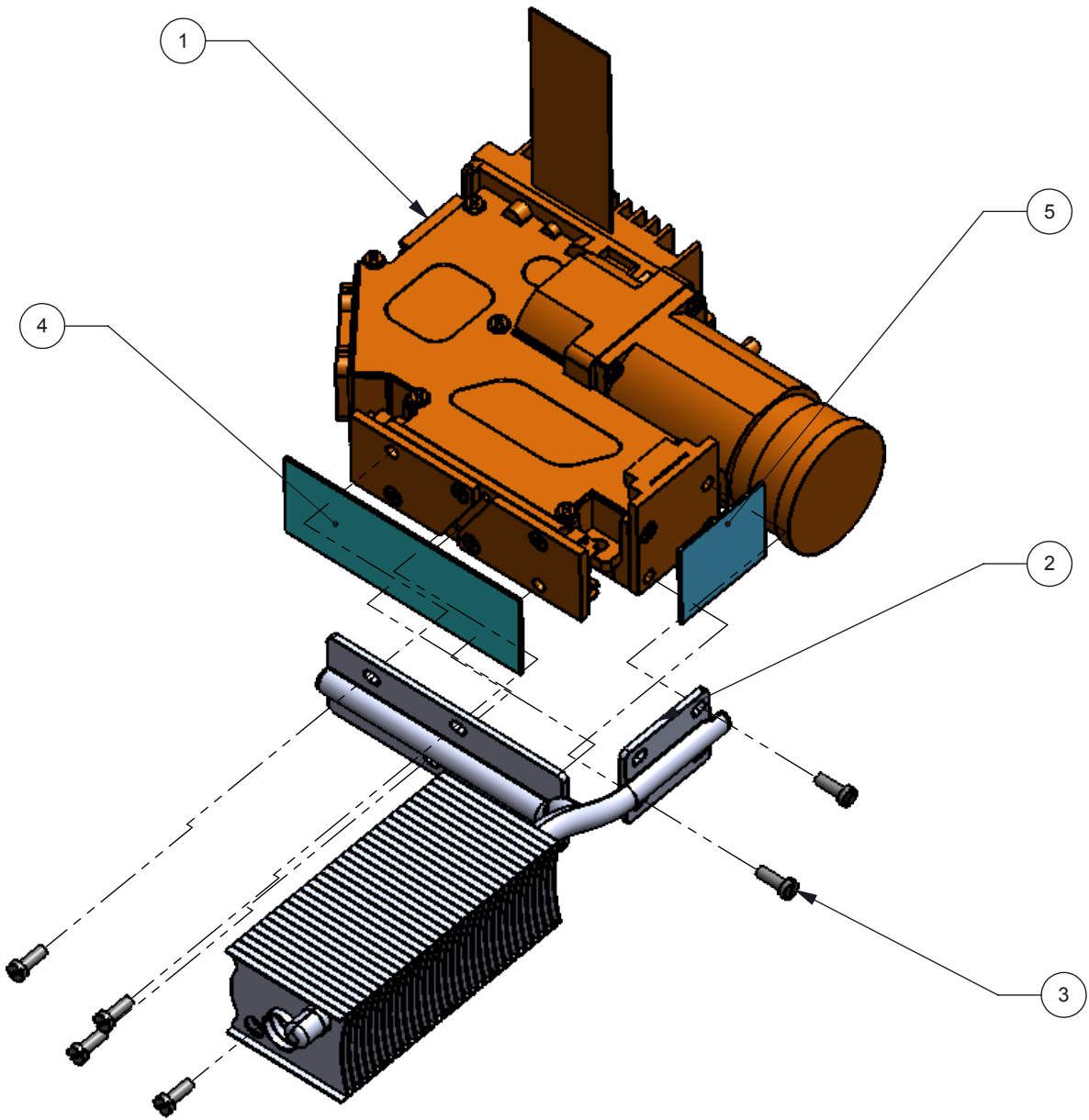

ITEM NO.	PART NUMBER	DESCRIPTION	QTY.
1	900-0021-00 H6	ePROTECH PT3 720P DISPLAY ENGINE	1
2	P5_32FIN_ASM	PT3 720P DISPLAY ENGINE HEATSINK	1
3	20595	M1.7 X 6MM FLAT HD SCREW (Metricscrews.us)	6
4	3010-EVM-RG-THERMAL-PAD	RED GREEN THERMAL PAD	1
5	3010-EVM-B-THERMAL-PAD	BLUE THERMAL PAD	1

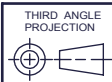

UNLESS OTHERWISE SPECIFIED

- DIMENSIONS ARE IN MILLIMETERS
- TOLERANCES: ANGLES $\pm 1^\circ$
2 PLACE DECIMALS ± 0.25
1 PLACE DECIMALS ± 0.50
- DIMENSIONAL LIMITS APPLY BEFORE PROCESSES
- INTERPRET DIMENSIONS IN ACCORDANCE WITH ASME Y14.5M-1994
- REMOVE ALL BURRS AND SHARP EDGES
- PARENTHETICAL INFO FOR REF ONLY

DWN
STEVE SMITH
Engr

DATE
7/19/2017

CQE/QA

CM

Apprvd



ENGINE HEATSINK ASSEMBLY

SIZE	DWG NO	3010-EVM-G2-ENGINE-HEATSINK-ASM	REV
B			A
SCALE 1:2		SHEET 1 OF 1	