

NOTES: UNLESS OTHERWISE SPECIFIED:

© COPYRIGHT 2017 TEXAS INSTRUMENTS
UNPUBLISHED, ALL RIGHTS RESERVED

REVISIONS			
REV	DESCRIPTION	DATE	BY
A	INITIAL RELEASE	1/25/2017	SS
B	UPDATED FOR FAN MOUNT CHANGE	2/3/2017	SS
C	UPDATED PART DESCRIPTIONS	7/21/2017	SS

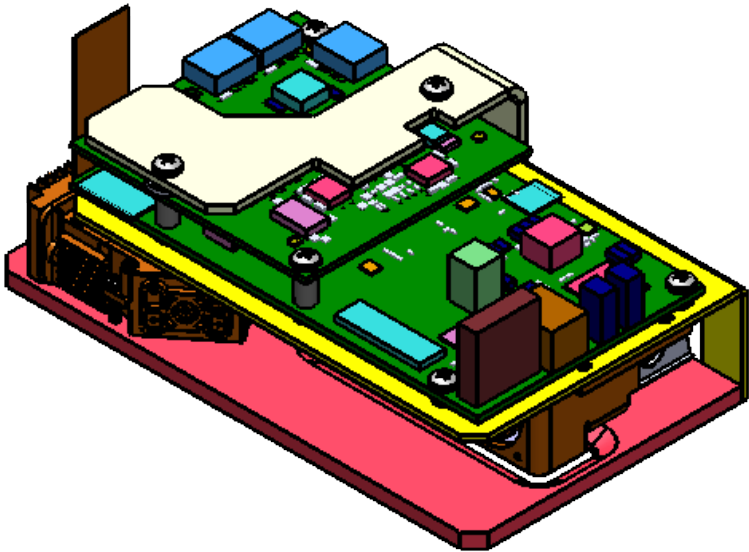
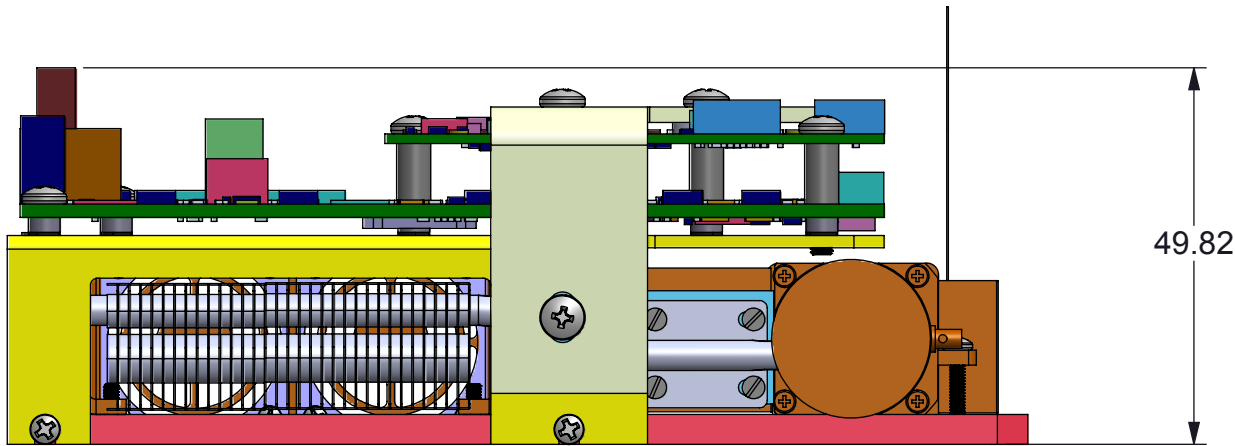
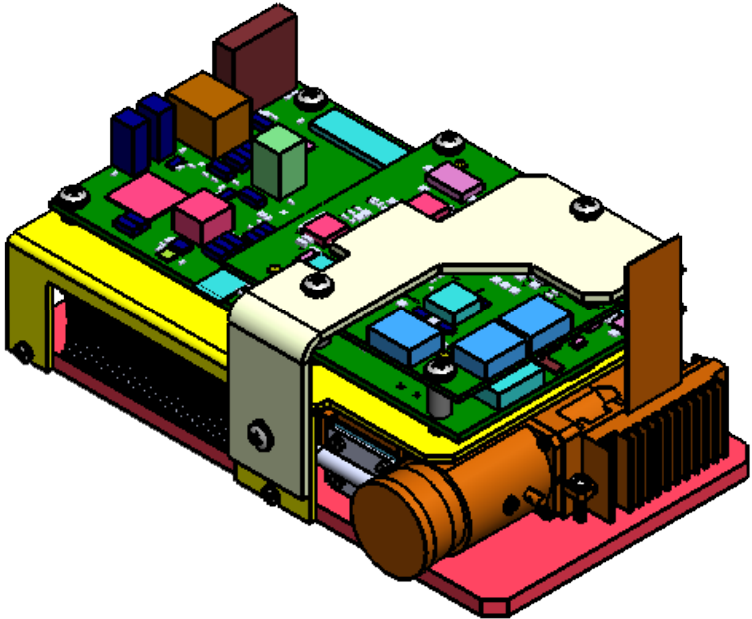
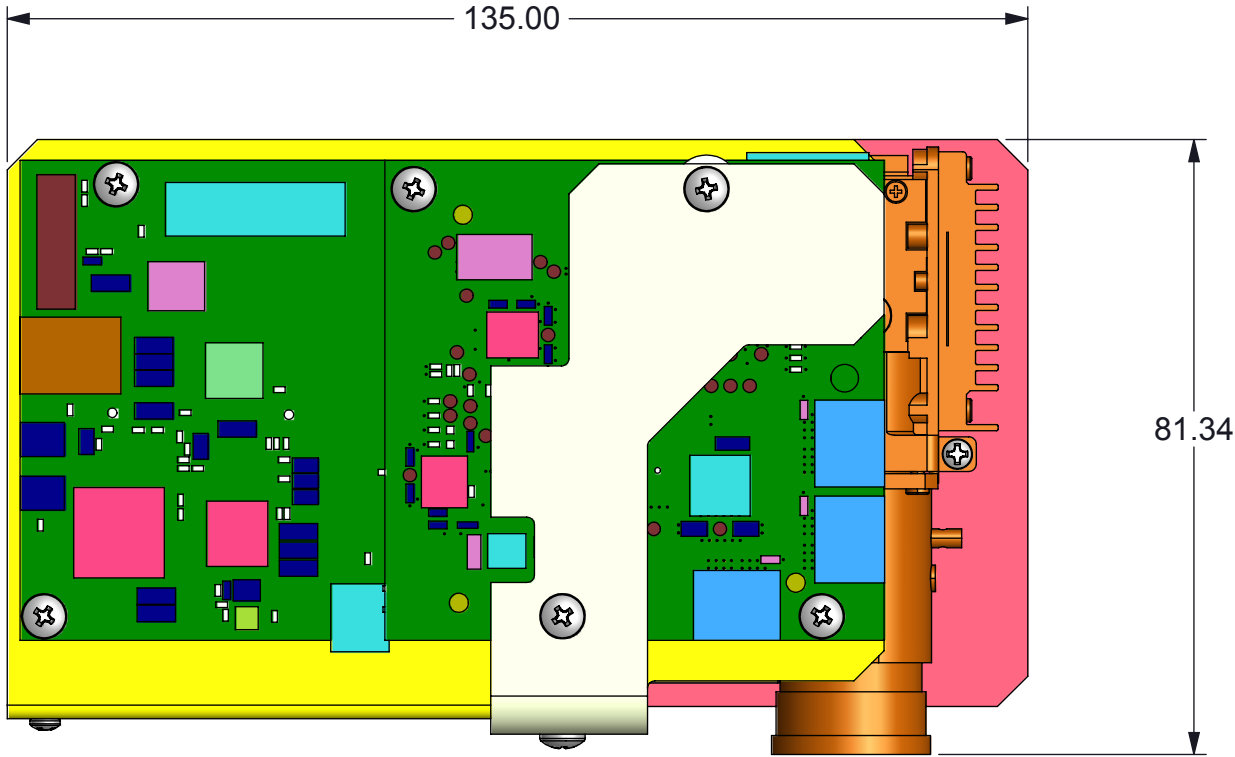

UNLESS OTHERWISE SPECIFIED

- DIMENSIONS ARE IN MILLIMETERS
- TOLERANCES: ANGLES $\pm 1^\circ$
2 PLACE DECIMALS ± 0.25
1 PLACE DECIMALS ± 0.50
- DIMENSIONAL LIMITS APPLY BEFORE PROCESSES
- INTERPRET DIMENSIONS IN ACCORDANCE WITH ASME Y14.5M-1994
- REMOVE ALL BURRS AND SHARP EDGES
- PARENTHETICAL INFO FOR REF ONLY

DWN
STEVE SMITH
Engr
STEVE SMITH
CQE/QA
CM
Apprvd

DATE
1/20/2017
1/27/2017

TEXAS
INSTRUMENTS

3010 EVM KIT

SIZE
B

DWG NO
3010-EVM-G2-SS-TOP-ASSEMBLY

REV
C

SCALE 1:1

SHEET 1 OF 2

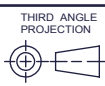

NEXT ASSY
USED ON
APPLICATION

D

C

B

A

D

C

B

A

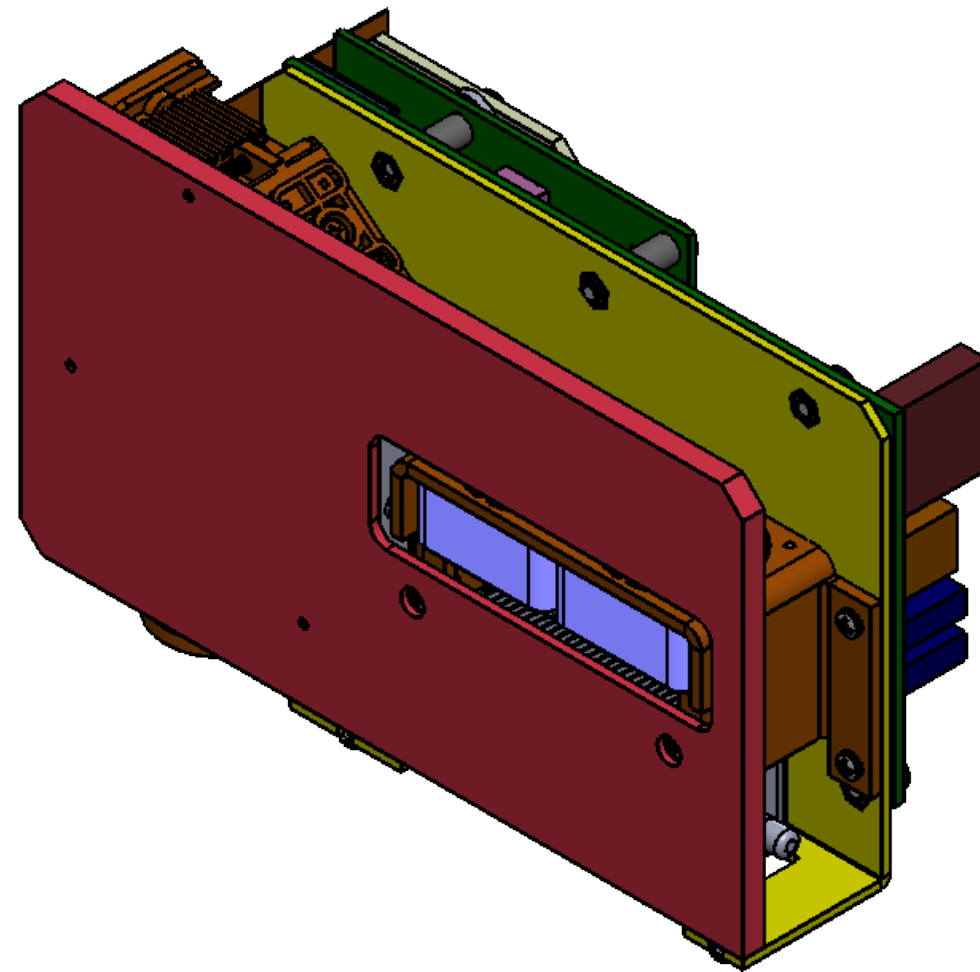
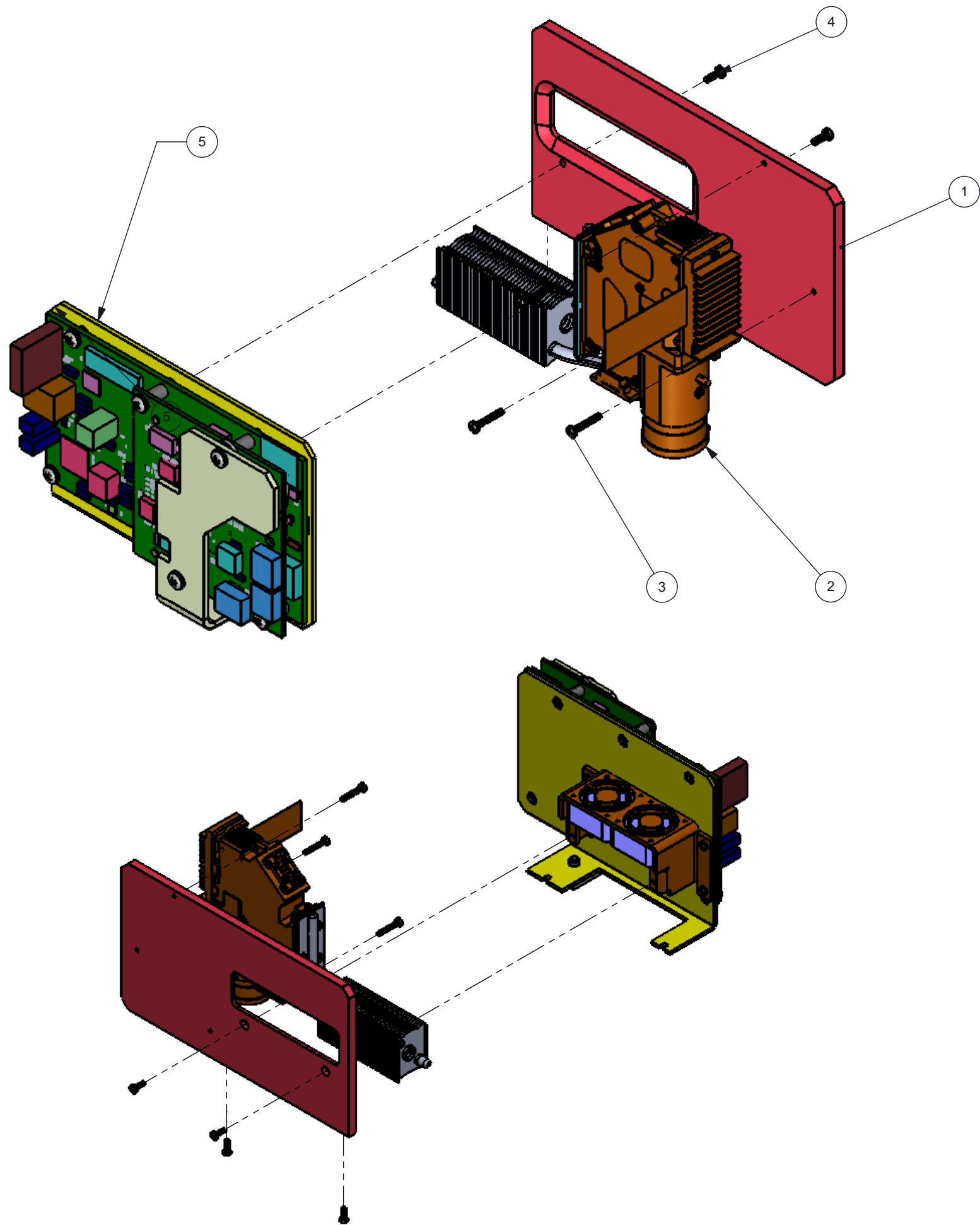

ITEM NO.	PART NUMBER	DESCRIPTION	QTY.
1	3010-EVM-G2-ENGINE-BASE-SS	ENGINE BASE	1
2	900-0021-00 H6	ePROTECH PT3 720P DISPLAY ENGINE	1
3	90116A022	M2 X 12MM LONG PAN HEAD (McMaster-Carr)	3
4	92005A023	M2 X 6MM LONG PAN HEAD (McMaster-Carr)	4
5	3010-EVM-G2-ELECT-ASM	3010 ELECTRONICS ASSEMBLY	1

